

NOTES

Do not scale this drawing.
It is the Contractor's responsibility to report any inconsistencies on the drawing, or between drawings, to the Architects and to request clarification and correction before proceeding. All dimensions to be checked on site prior to commencement of construction and prior to ordering of materials and components.
Following electronic transfer of drawing information, it is the responsibility of the recipient to ensure that the drawing is complete, to be used for its intended purpose, and to be stored, copied, used or delivered to or by third parties without our permission. If revision or property and must be returned on request.
All rights described in Chapter IV of The Copyright, Design and Patents Act 1988 have been generally asserted.

REVISION DESCRIPTION DATE DRAWN CHECKED

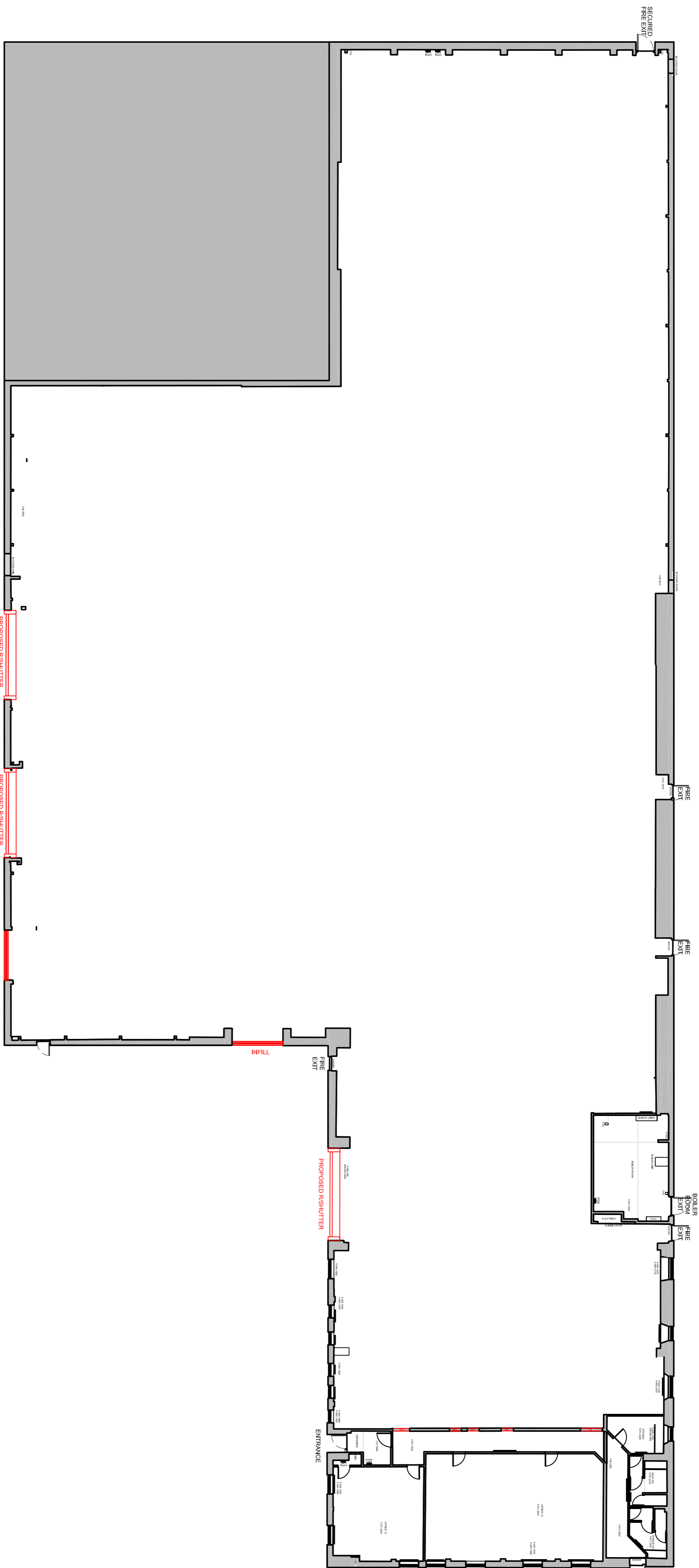

NOTE: SURVEY CARRIED OUT BY PINNACLE PHOENIX contract no. 8280

40B Spains Wharf
Glasgow
G4 9TH
t: 0141 649 2296
&
Cubic CoWork
Unit 5 Lisburn Square
B128 1TS
t: 02892 528 078
e-mail: info@10architects.com



A10 Architects Ltd is registered in Scotland as a limited liability Company with the registered number SC232964. Registered office: 40B Spains Wharf, Glasgow, G4 9TH
PROJECT
PENN
PA3 TRX

TITLE
PROPOSED
GROUND FLOOR
DEMOLITION LAYER OFF

JOB NUMBER	DRAWING NUMBER	REV
1525	AL(3)002	
SCALE	SHEET SIZE	DATE
1:200	A1	19/7 2020
WORK STAGE	PURPOSE	DRAWN BY
1	INFORMATION	RS
		CHECKED BY
		DC